

• GPS Coordinates N44° 14' 51", W87° 41' 51"

Reports indicate that additional possible human bone fragments were found at the above GPS coordinates. These locations correspond to ashes and burnt debris found in the quarry adjoining the Avery Salvage Yard. The location is depicted in the map shown below in Figure 50.

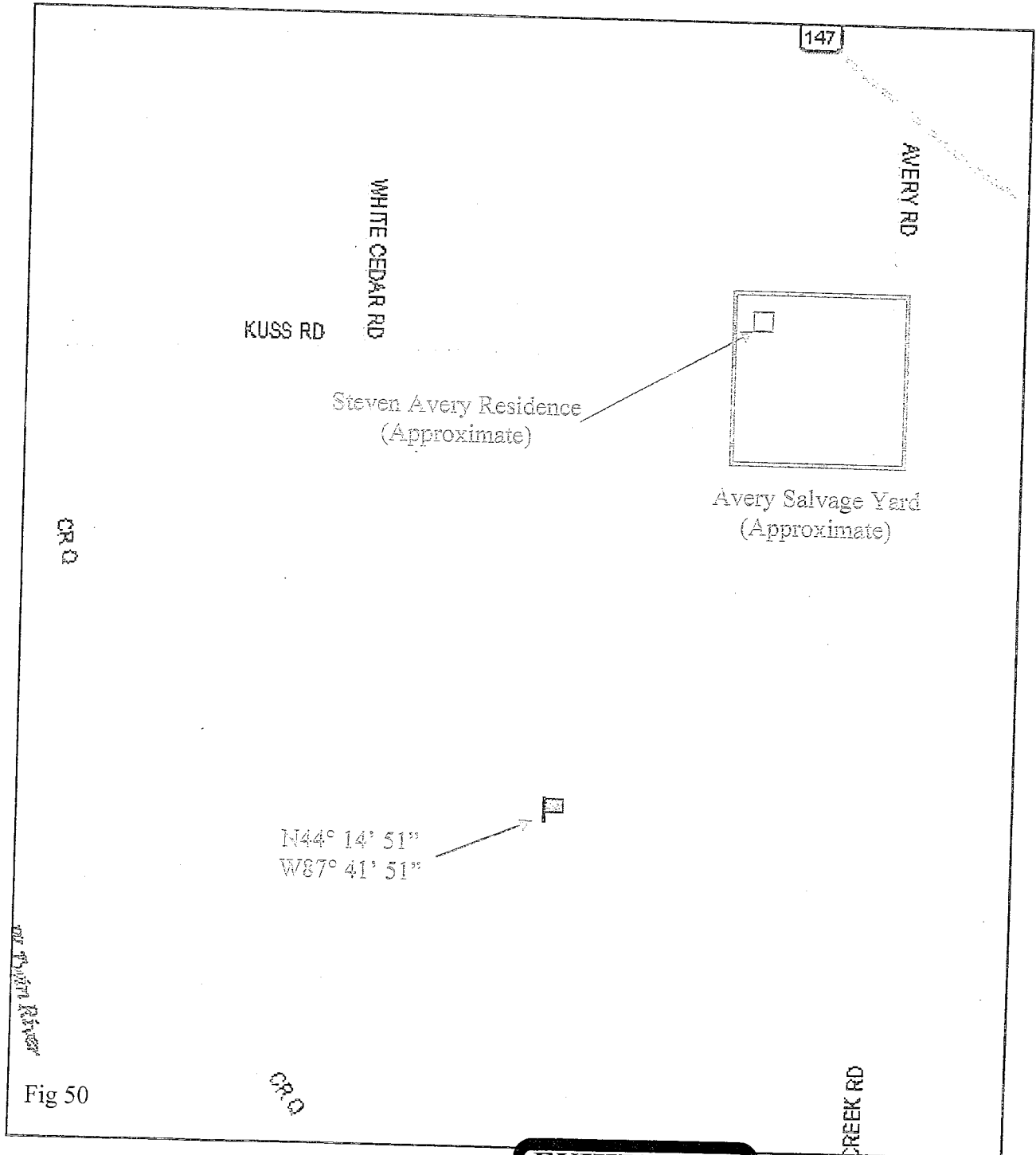

Fig 50

**EXHIBIT 402**  
05 CF 381  
DATE 02-28-07 PB  
Initials

Evidence Tag Number 8675

Evidence Tag 8675, consisted of fragments representing the following possible human pelvic bones:

1. Sacrum Fragment
2. Innominate Fragments

In her narrative reports, Dr. Eisenberg notes that the bone fragments shown above have cut marks. As identifications of such a nature fall outside of this author's expertise, the reports prepared by the Forensic Anthropologist should be referenced for bone condition.

